

INDEX
B LA 6 012

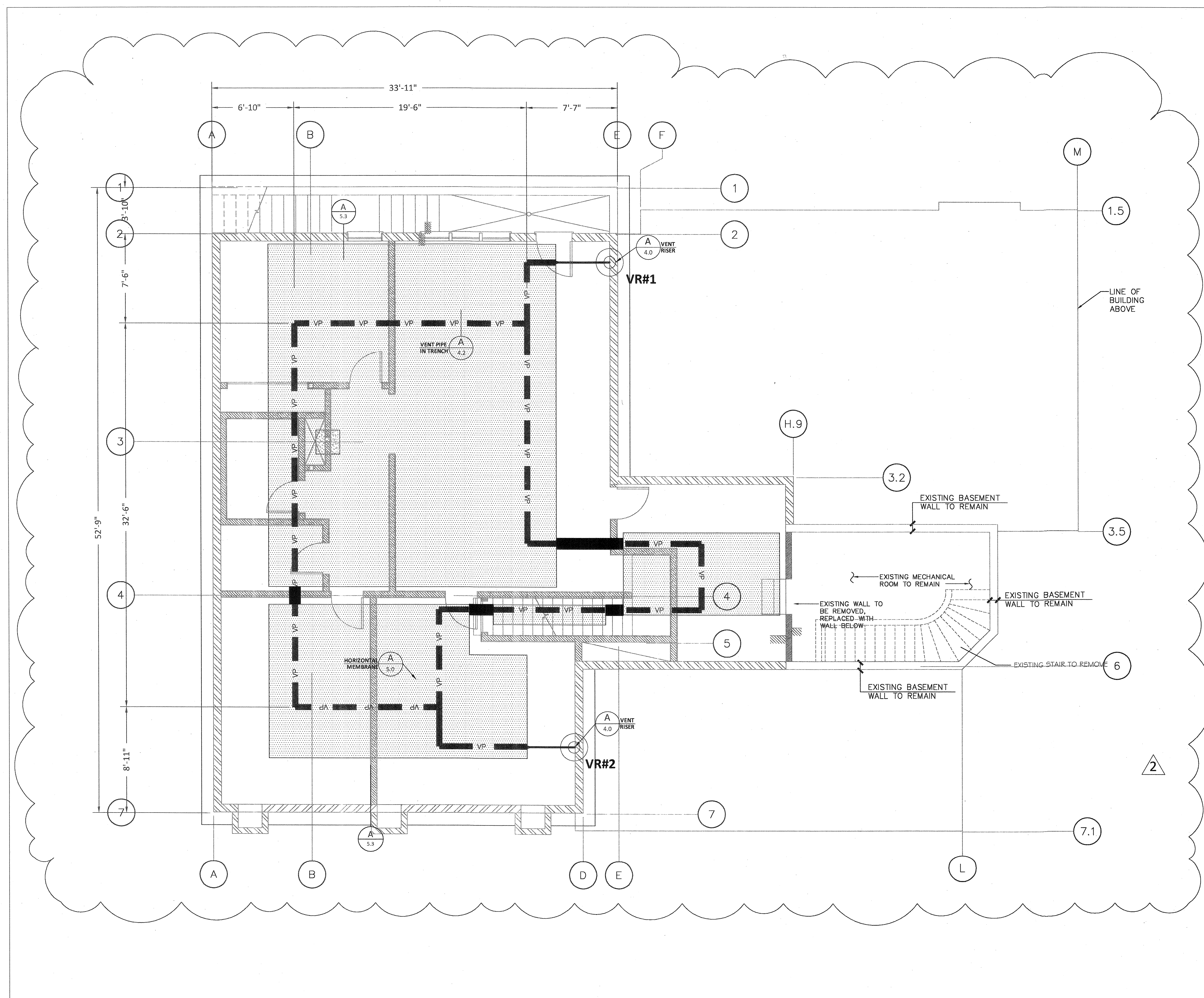

NOTES

- 1 PRIOR TO TRENCHING, CONTRACTOR SHALL VERIFY VENT RISER LOCATIONS WITH BUILDING CONTRACTOR & ARCHITECT FOR STRUCTURAL FRAMING, DOOR AND WINDOW LOCATIONS.
- 2 VENT PIPING MAY BE FIELD LOCATED TO COINCIDE WITH UTILITY TRENCHES, WITH APPROVAL OF ARCHITECT.
- 3 VENT RISERS MAY BE FIELD ADJUSTED TO AVOID DOORS, WINDOWS, OR OTHER ARCHITECTURAL INTERFERENCE.
- 4 INTERIOR SIDE OF FOOTINGS NEED TO BE TROWELED SMOOTH FOR THE METHANE BARRIER TERMINATIONS.
- 5 FIELD SITUATIONS NOT SPECIALLY DETAILED SHALL BE HANDLED PER THE INTENT OF THESE PLANS AND SPECIFICATIONS WITH THE APPROVAL OF THE METHANE ENGINEER. CONTRACTOR MAY SUBMIT SHOP DRAWINGS FOR ALTERNATIVE METHODS, WHICH MAY BE APPROVED IF THEY REPRESENT NO ADDITIONAL COST TO THE OWNER.
- 6 BUILDING DIMENSIONS ARE APPROXIMATE AND PROVIDED BY OTHERS.
- 7 THE UPPER SURFACE OF THE GAS MEMBRANE BARRIER SHALL BE PROTECTED BY A MINIMUM 2" SAND LAYER OR 2" THICK LEAN CONCRETE PLACED BETWEEN THE FLOOR SLAB AND THE MEMBRANE.
- 8 NO VENT RISER SHALL BE INSTALLED WITHIN 10 FT. OF THE EXTREME OUTSIDE EDGE OF A FIRE PLACE.

CALCULATION FOR NO. OF VENT RISERS:

MEMBRANE AREA = 1,734 SQUARE FEET

USING 2" DIA VENT RISER: $1,734 / 2,500 = 0.7$
MIN. 2 VENT RISERS REQUIRED PER TABLE 2 ON SHEET GC-1.3

PROVIDED 2 VENT RISERS

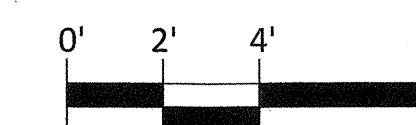
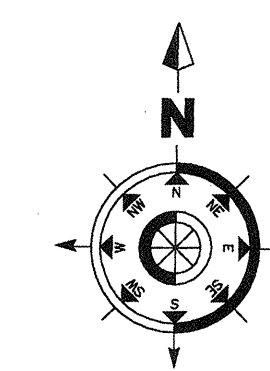

LEGEND

- MEMBRANE LIMITS
- VP VENT PIPE
- VR#2 VENT RISER

METHANE SPECIALISTS
621 VIA ALONDRA
SUITE 610
CAMARILLO, CA - 93012
TEL: 805.987.5356
FAX: 805.987.3968
www.methanespecialists.com

ENGINEER STAMP

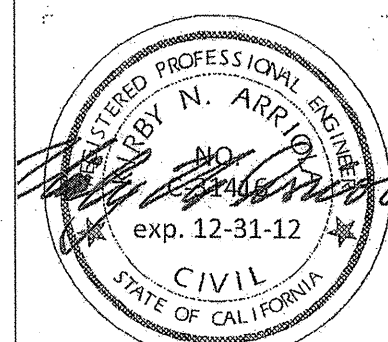

NOTE: THESE METHANE SPECIALISTS PLANS, NOTES AND SPECIFICATIONS ARE PROPRIETARY AND ARE NOT TO BE COPIED, IMITATED OR USED EXCEPT BY CLIENT AND FOR THE SPECIFIC PROJECT STATED HEREON, WITHOUT PRIOR WRITTEN APPROVAL OF METHANE SPECIALISTS.

DESIGN

DSN: C. TEKAAT

DRN: C. TEKAAT

CHK: K. ARRIOLA

DATE: JUNE 2012

REVISIONS

Δ	
Δ	
Δ	
Δ	
Δ	DB DESIGN REVISIONS 6.6.2012
Δ	CT PLAN CHECK SUBMITTAL 10.10.2011
NO. INT.	DESCRIPTION: DATE:

PROJECT FOR:

ALON MIZRAHI
166 N. FORMOSA AVE
LOS ANGELES, CA - 90036
TEL-323.804.8444

PROJECT

J2499

217 S. MCCADDEN PLACE
LOS ANGELES, CA - 90004

AN ADDITION TO AN EXISTING SINGLE-FAMILY RESIDENCE TO BE BUILT OVER A SUBTERRANEAN LEVEL AND A DETACHED GARAGE ON-GRADE

SHEET TITLE

SUB-SLAB
VENT PIPE and
MEMBRANE
PLAN
BASEMENT

GC-3.0

7 OF 19